

Sistema a Binario Magnetico

INSTALLATION INSTRUCTION MAGNETIC TRACK ACCESSORIES

NO	NAME	SKU	PICTURE	DESCRIPTION
1.	Track connector set (Metal Plate)	7971		To be used for track straight line splicing, 1PC for each segment splicing
2.	Track connector set (straight connector)	7971		Option for Conductive Linear Connection of Track
3.	90°D Connector	7972		Surface mounted / Pendant / Recessed (without wings) track horizontal 90° corner splicing
4.	Outer corner connector	7973		For vertical track splicing
5.	X connector	7974		Surface mounted / Pendant / Recessed (without wings) track, + type connector splicing only
6.	T connector	7975		Only for bright/ lifted/ embedded installation without side rail T type splicing
7.	Pendant accessory	7977		Used for installation/ marking of track suspension line 1.5m (customizable length of suspension line)
8.	Recessed kit	7970		Installation of recessed (without wings) track only Installation and fixed use
9.	Live end connector	7979		Conductive use/ optional purchase for connection between track line and power supply
10.	Track cover	7978		Magnet track PC Cover for track without lamp
11.	L type track connector			Conductive use/optional purchase for L type rail connections
12.	4x30mm Tapping screw			For track installation and fixed use
13.	End cap			Used for installation of end caps at both ends of track

TRACK CONNECTOR INSTALLATION

Track Straight Connector

90° Corner Connector

Outer Corner Connector

T Type Connector

X Type Connectors

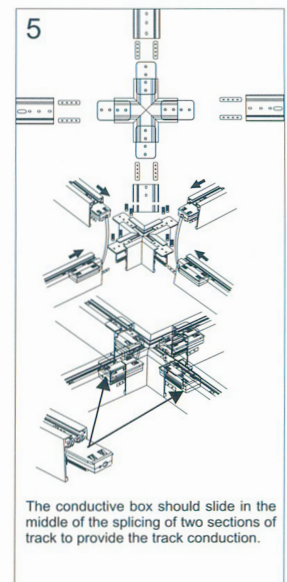
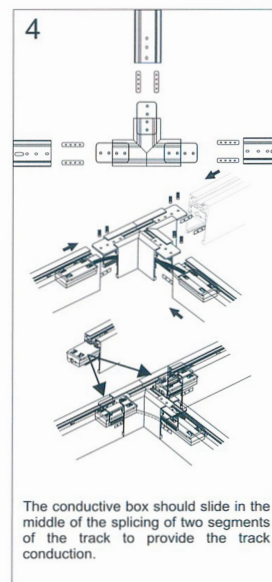
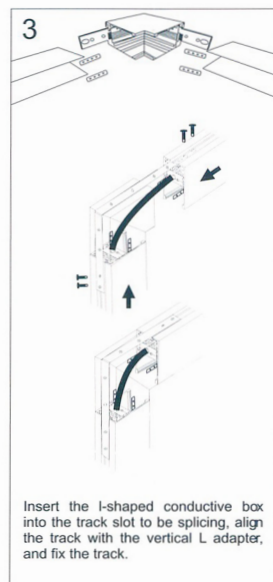
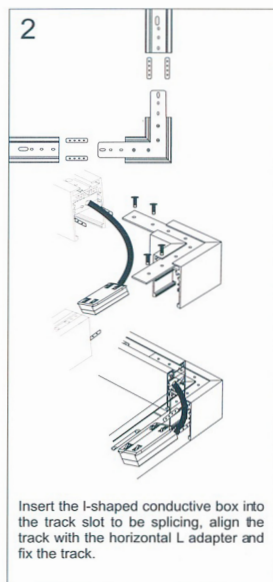
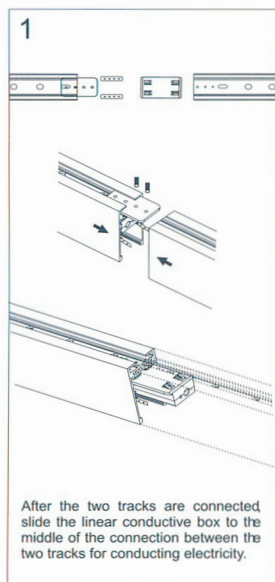

Sistema a Binario Magnetico



VT-4315

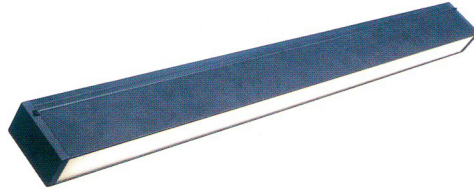

VT-4131



VT-4121



VT-4215



VT-4141



VT-4143



VT-4210

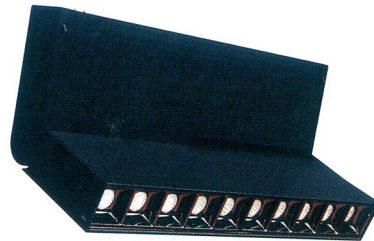

VT-4220



TRACK RAIL

TECHNICAL SPECIFICATIONS:

MODEL No.	WATTS	LUMENS	BEAM ANGLE	CRI	VOLTAGE	UNIT SIZE	IP RATING	MATERIAL	UGR
VT-4121	20W	2000lm	30°	90	DC:24V	652x35x59mm	IP20	Aluminum	
VT-4131	30W	2700lm	30°	90	DC:24V	970x35x59mm	IP20	Aluminum	
VT-4141	1W	35lm	30°	90	DC:24V	45x35x59mm	IP20	Aluminum	<19
VT-4143	3W	240lm	30°	90	DC:24V	106x35x59mm	IP20	Aluminum	<19
VT-4210	10W	700lm	30°	90	DC:24V	137x35x180mm	IP20	Aluminum	<19
VT-4220	20W	1200lm	30°	90	DC:24V	270x35x180mm	IP20	Aluminum	<19
VT-4215	15W	900lm	36°	90	DC:24V	166x100x55mm	IP20	Aluminum	<19
VT-4315	15W	1000lm	36°	90	DC:24V	L300xD55mm	IP20	Aluminum	<19