

# INSTRUCTION MANUAL

## ZigBee+RF Switch Module

### MS-104Z

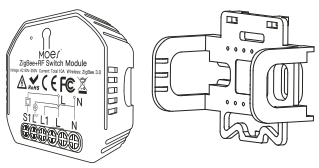

WORKS WITH Google Assistant

WORKS WITH Amazon Alexa

Global international operation Whenever & Wherever You are, All-in-one Mobile App

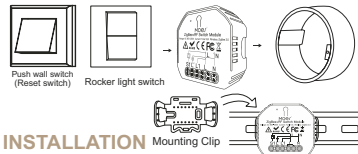
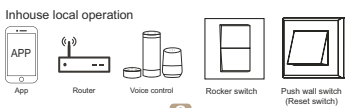
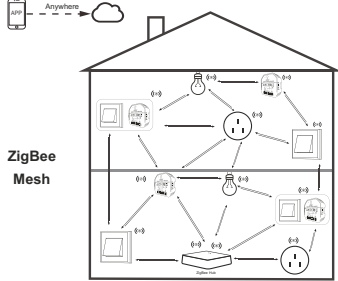

- ### INSTALLATION
- ▲ Warnings: This is a ZigBee smart module switch that must be used under ZigBee gateway hub connected with ZigBee protocol.
- Installation must be carried out by a qualified electrician in accordance with local regulations.
  - Keep the device out of the reach of children and away from water, damp or hot environment.
  - Install the device away from strong signal sources such as microwave oven that may cause signal interruption resulted in abnormal operation of the device.
  - Obstruction by concrete wall or metallic materials may reduce the effective operation range of the device and should be avoided.
  - Do NOT attempt to disassemble, repair or modify the device.

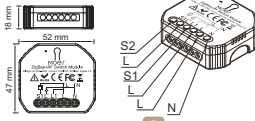

## TECHNICAL SPECIFICATIONS

Product type	ZigBee +RF Switch Module
Voltage	90-250V AC
Current	10A
Wireless Protocol	ZigBee 3.0
Operation temp.	-10°C - +40°C
Case temp.	Tc: +80°C (Max.)
Operation range	≤200 m
Dims (WxDxH)	52x47x18 mm
IP rating	IP20
Warranty	1 year

## WIRING DIAGRAM

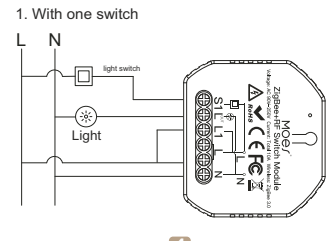

### 2. Without switch

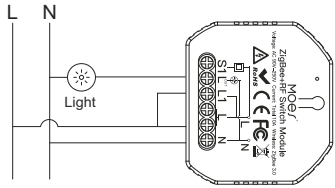

### 3. With 2 Way switches

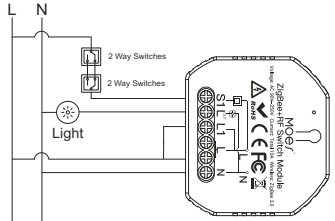

### 4. With Wall Socket

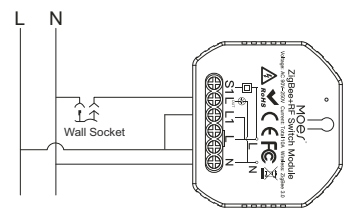

### Wiring Instructions and Diagrams

- Turn off the power supply before carrying out any electrical installation work.
- Connect wires according to the wiring diagram.
- Insert the module into the junction box.
- Connect the power supply and follow switch module configuration instructions.

**Notes:** Put your smartphone close to the switch module when you're configuring, and make sure you have min. 50% Wi-Fi signal.

## FAQ:

- Q1: What should I do if I can't configure the switch module?
- Please check whether device is powered on.
  - Make sure your mobile and ZigBee gateway hub are under the same 2.4GHz WiFi network.
  - Whether it's in good internet conditions.
  - Make sure the password entered in App is correct.
  - Make sure the wiring is correct.
- Q2: What device can be connected to this ZigBee switch module?
- Most of your household electrical appliances can be, such as lamps, laundry machine, coffee maker, etc.
- Q3: What happens if the WiFi goes off?
- You can still control the device connected to the switch module with your traditional switch and once WiFi is active again the devices connected to App will connect automatically for normal control.
- Q4: What should I do if I change the WiFi network or change the password?
- You have to re-connect your ZigBee gateway hub to the new WiFi network according to the App User Manual.

## MANUAL OVERRIDE

The ZigBee switch module terminal reserves the access of manual override function for the end-user to switch on/off.

- Switch on/off for permanent on/off function.

### Notes:

- Both the adjustment on App and switch can be reset, the last adjustment remains in memory.
- The App control is synchronized with the manual switch.

### APP USER MANUAL



iOS App / Android App

Scan the QR code to download Smart Life App, or you can also search keyword "Smart Life" at App Store or Googleplay to download App.

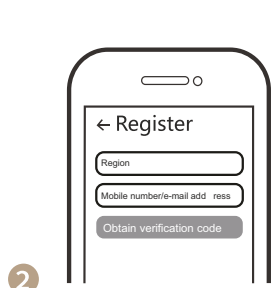

Log in or register your account with your mobile number or e-mail address. Type in the verification code sent to your mobile or mail box, then set your login password. Click "Create Family" to enter into the App.

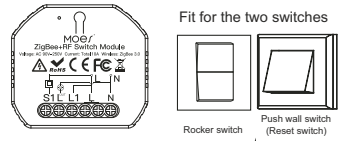

- 3 Zigbee Link/Reset:**
- For reset switch:** press the switch button for 10 times to hear the beep sounds continuously.
  - For rocker light switch:** press the switch button for 20 times (ON/OFF cycle for 10 times) to hear the beep sounds continuously.
  - For reset button:** long press the button on the module to hear the beep sounds as Di-Di (2 times) and long press the button again to hear the beep sounds continuously.

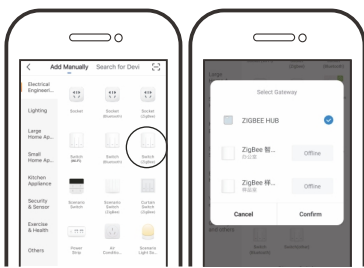

Open the App, select "+" on top right, choose "Switch (ZigBee)" to add device. And select the right Gateway to confirm the connection.

**Note:** Make sure you have successfully connected one ZigBee gateway hub.



Confirm the ZigBee switch module is beeper rapidly. (twice a second).

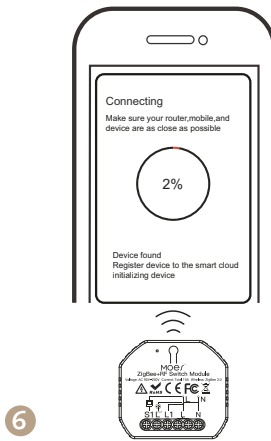

The connecting will take about 10-120 seconds to complete depending on your network condition.

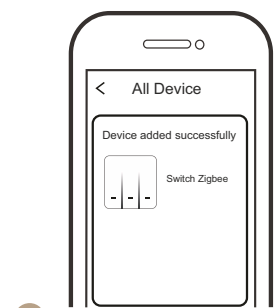

When pairing is done, the ZigBee switch will be shown on the App.

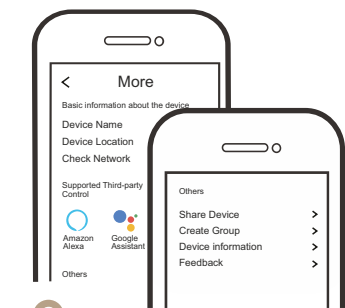

Connect to Amazon Alexa or Google Assistant for voice control, or share the devices with your families or friends.

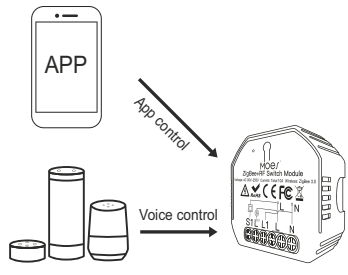

Enjoy your smart life of home automation for lighting control by using our All-in-one mobile App wherever you are in the world or simply by voice control when you are sitting at home comfortably.

## Pair and clear up the RF code

### 1. How to pair the RF code

- 1.1 For reset switch:** press the switch for 5 times to hear the beep sounds as Di-Di (2 times) for successful pairing.
- 1.2 For rocker light switch:** press the switch for 10 times (ON/OFF cycle for 5 times) to hear the beep sounds as Di-Di (2 times) for successful pairing.
- 1.3 For reset button:** long press the button on the module to hear the beep sounds as Di-Di (2 times) for successful pairing.

### 2. How to clear up the RF code

- 2.1 For reset switch:** press the switch for 5 times to hear the beep sounds as Di-Di (2 times), and press the switch for 5 times again after 5 seconds to hear the beep sounds as Di-Di-Di-Di (4 times) for successful clearing.

- 2.2 For rocker light switch:** press the switch for 10 times (ON/OFF cycle for 5 times) to hear the beep sounds as Di-Di (2 times), and press the switch for 10 times (ON/OFF cycle for 5 times) again after 5 seconds to hear the beep sounds as Di-Di-Di-Di (4 times) for successful clearing.
- 2.3 For reset button:** long press the button on the module to hear beep sounds as Di-Di (2 times), release your finger for 5 seconds and long press the button again to hear the beep sounds as Di-Di-Di-Di (4 times) for successful clearing.

### 3. How to achieve multi-control association

**Note:** Please confirm you have successfully finished the zigbee link method above for adding this switch to your Smart Life App before the association.

1. WiFi add another smart switch to the same Smart Life/Tuya App. (If there is a smart switch having been added before to the app, just go to next step.)

**Note:** There is no need to wire the new added switch to the light, only L and N are required for wiring.

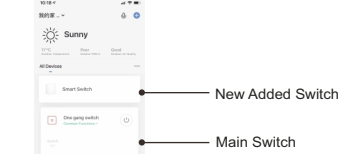

- Then you will see two devices in the app and click the main switch (as One gang switch as below) by entering into the next operation.
- Click "L" in the upper right corner and choose "Multi-Control Association", and then click "+" in the right corner

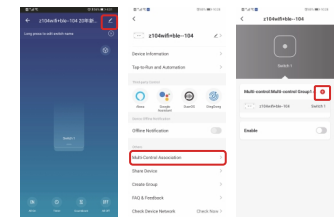

- Choose the switch that you want to associate to and then choose the switch button that you want to control the same light.

5. Then go back to previous page, you will see two items in the page, one is your main switch, the other is the one you associate just now. **Note:** Please confirm the associated switch is enabled.

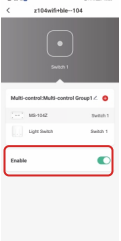

6. Now you are able to control your light with two switches. Do not associate another button in the same switch for multi-control.

7. If you want to add another third or more smart switches to control your light, just repeat the steps above. And you will see the result as below when you associate another new switch.

