

Door and Window Sensor

Product specifications

Product name	Door and window sensor
Model number	ZXZDS
Battery specifications	CR2032 (Replaceable)
Operating temperature	-10°C~50°C
Operating humidity	0-95%RH (no condensation)
Wireless connection	ZigBee

Packing list

- Door and window sensor x 1
- Back adhesive x 2
- Battery x 1
- Instruction manual x 1
- Magnet x 1

Please read the instruction manual carefully before using the product

Product description

The door and window sensor detects the opening or closing of the door and window, and works in conjunction with other devices to design and implement smart application scenarios. Ensure that the door magnet is located on the side of the alignment mark.

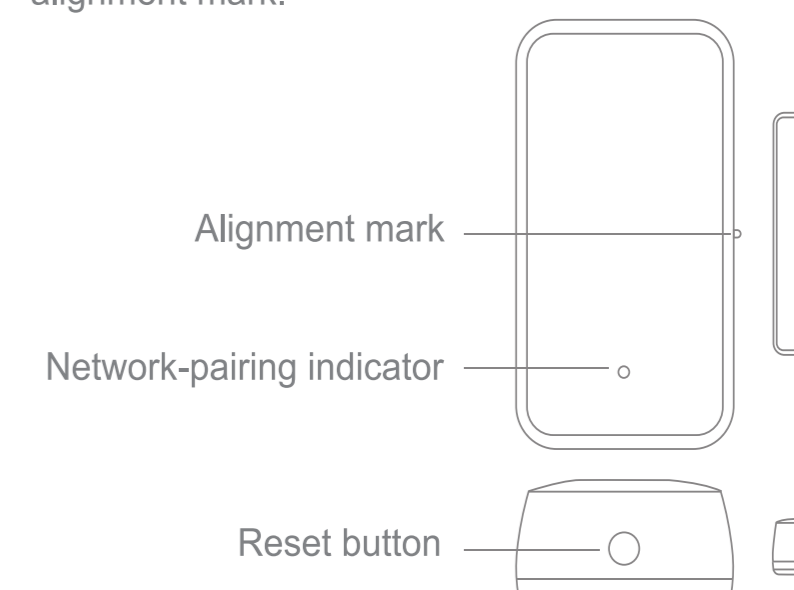

Preparation for use

- ① Mobile phone is connected to Wi-Fi

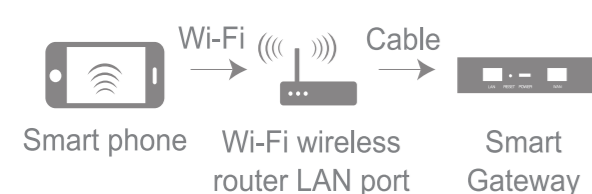

Ensure that the product is within the effective coverage of the smart host (gateway) ZigBee network to ensure an effective connection between the product and the smart host (gateway) ZigBee network.

*Make sure the smart host has been added.

Preparation for use

- ② Download and open the App

In the App Store, search for "Smart Life" or scan the QR code on the package/manual to download and install the smart App.

If you are downloading this App for the first time, please tap the "Register" button to register your account; If you already have an account, click the "Login" button.

Network settings

- Load battery to the device while ensuring that the phone is connected to the network and the smart gateway has been added successfully;
- Open the App and tap "Add sub-device" on the "Smart gateway" screen. Then, select "Door and window sensor";

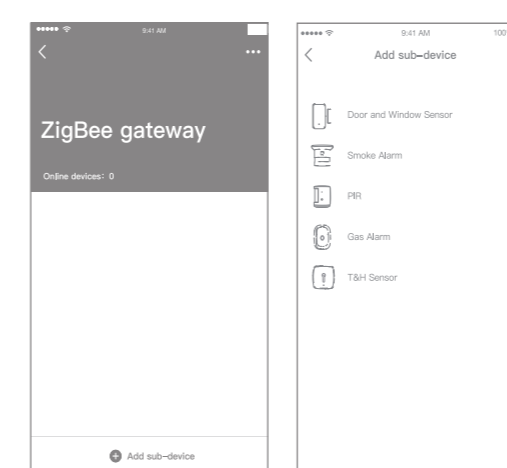

- Press and hold the reset button for 5 seconds, until the network indicator light begins flashing. Follow the App instructions to add the device.

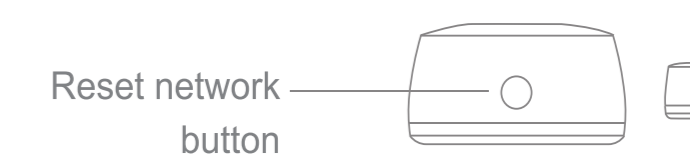

- Once the device has been successfully added, you will be able to find the device in the "My home" list.